

**HMOLM**

**CILINDRO DOPPIO EFFETTO STANDARD  
STANDARD DOUBLE ACTING CYLINDER**

**Series C200**

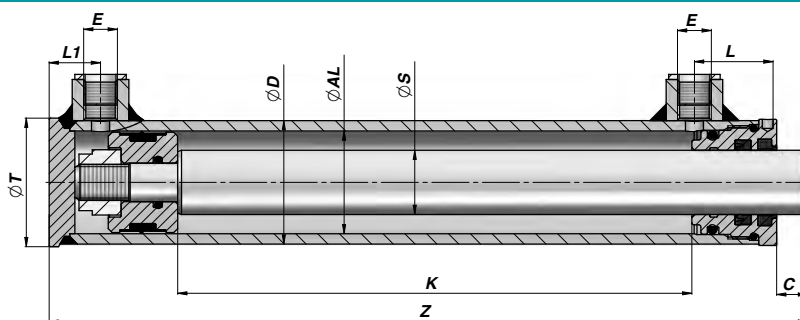
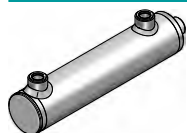

| Codice Code               | K   | Z   | kg                        | E BSP | L  | L1 | C  | ØT | Codice Code     | K   | Z   | kg    |
|---------------------------|-----|-----|---------------------------|-------|----|----|----|----|-----------------|-----|-----|-------|
| <b>ØD 48 ØAL 40 ØS 20</b> |     |     | <b>ØD 48 ØAL 40 ØS 25</b> |       |    |    |    |    |                 |     |     |       |
| HMOLM0400200100           | 100 | 195 | 1,75                      | 1/4"  | 32 | 20 | 12 | 50 | HMOLM0400250100 | 100 | 195 | 1,90  |
| HMOLM0400200150           | 150 | 245 | 2,09                      |       |    |    |    |    | HMOLM0400250150 | 150 | 245 | 2,31  |
| HMOLM0400200200           | 200 | 295 | 2,43                      |       |    |    |    |    | HMOLM0400250200 | 200 | 295 | 2,72  |
| HMOLM0400200250           | 250 | 345 | 2,76                      |       |    |    |    |    | HMOLM0400250250 | 250 | 345 | 3,14  |
| HMOLM0400200300           | 300 | 395 | 3,09                      |       |    |    |    |    | HMOLM0400250300 | 300 | 395 | 3,53  |
| HMOLM0400200400           | 400 | 495 | 3,78                      |       |    |    |    |    | HMOLM0400250400 | 400 | 495 | 4,35  |
| HMOLM0400200500           | 500 | 595 | 4,46                      |       |    |    |    |    | HMOLM0400250500 | 500 | 595 | 5,17  |
| <b>ØD 58 ØAL 50 ØS 25</b> |     |     | <b>ØD 58 ØAL 50 ØS 30</b> |       |    |    |    |    |                 |     |     |       |
| HMOLM0500250100           | 100 | 205 | 2,60                      | 3/8"  | 36 | 22 | 13 | 60 | HMOLM0500300100 | 100 | 205 | 2,78  |
| HMOLM0500250150           | 150 | 255 | 3,06                      |       |    |    |    |    | HMOLM0500300150 | 150 | 255 | 3,32  |
| HMOLM0500250200           | 200 | 305 | 3,52                      |       |    |    |    |    | HMOLM0500300200 | 200 | 305 | 3,87  |
| HMOLM0500250250           | 250 | 355 | 3,97                      |       |    |    |    |    | HMOLM0500300250 | 250 | 355 | 4,41  |
| HMOLM0500250300           | 300 | 405 | 4,43                      |       |    |    |    |    | HMOLM0500300300 | 300 | 405 | 4,95  |
| HMOLM0500250400           | 400 | 505 | 5,34                      |       |    |    |    |    | HMOLM0500300400 | 400 | 505 | 6,03  |
| HMOLM0500250500           | 500 | 605 | 6,27                      |       |    |    |    |    | HMOLM0500300500 | 500 | 605 | 7,12  |
| <b>ØD 68 ØAL 60 ØS 30</b> |     |     | <b>ØD 68 ØAL 60 ØS 35</b> |       |    |    |    |    |                 |     |     |       |
| HMOLM0600300100           | 100 | 220 | 3,77                      | 3/8"  | 39 | 25 | 13 | 70 | HMOLM0600350100 | 100 | 220 | 3,99  |
| HMOLM0600300150           | 150 | 270 | 4,36                      |       |    |    |    |    | HMOLM0600350150 | 150 | 270 | 4,68  |
| HMOLM0600300200           | 200 | 320 | 4,95                      |       |    |    |    |    | HMOLM0600350200 | 200 | 320 | 5,37  |
| HMOLM0600300250           | 250 | 370 | 5,54                      |       |    |    |    |    | HMOLM0600350250 | 250 | 370 | 6,06  |
| HMOLM0600300300           | 300 | 420 | 6,13                      |       |    |    |    |    | HMOLM0600350300 | 300 | 420 | 6,75  |
| HMOLM0600300400           | 400 | 520 | 7,32                      |       |    |    |    |    | HMOLM0600350400 | 400 | 520 | 8,14  |
| HMOLM0600300500           | 500 | 620 | 8,50                      |       |    |    |    |    | HMOLM0600350500 | 500 | 620 | 9,52  |
| <b>ØD 78 ØAL 70 ØS 35</b> |     |     | <b>ØD 78 ØAL 70 ØS 40</b> |       |    |    |    |    |                 |     |     |       |
| HMOLM0700350100           | 100 | 220 | 4,82                      | 3/8"  | 39 | 25 | 13 | 80 |                 |     |     |       |
| HMOLM0700350150           | 150 | 270 | 5,56                      |       |    |    |    |    |                 |     |     |       |
| HMOLM0700350200           | 200 | 320 | 6,30                      |       |    |    |    |    | HMOLM0700400200 | 200 | 320 | 6,79  |
| HMOLM0700350250           | 250 | 370 | 7,04                      |       |    |    |    |    | HMOLM0700400250 | 250 | 370 | 7,64  |
| HMOLM0700350300           | 300 | 420 | 7,80                      |       |    |    |    |    | HMOLM0700400300 | 300 | 420 | 8,50  |
| HMOLM0700350400           | 400 | 520 | 9,27                      |       |    |    |    |    | HMOLM0700400400 | 400 | 520 | 10,21 |
| HMOLM0700350500           | 500 | 620 | 10,76                     |       |    |    |    |    | HMOLM0700400500 | 500 | 620 | 11,94 |

MATERIALE TUBO: ACCIAIO S1 52.3 DIN 2393 ISO H9  
TUBE MATERIAL : STEEL S1 52.3 DIN 2393 ISO H9

MATERIALE ASTA: ACCIAIO UNI C45 SAE 1045 CROMO 25 µm ±5 Rating 9 / 200h ISO 10289 - 1999/ISO 9227-NSS  
ROD MATERIAL : STEEL UNI C45 SAE 1045 CHROME 25 µm ±5 Rating 9 / 200h ISO 10289 - 1999/ISO 9227-NSS

CARATTERISTICHE TECNICHE : VEDI PAGINA 30 - TECHNICAL SPECIFICATIONS : SEE PAGE 30