

**PRESSOSTATO REGOLABILE  
ADJUSTABLE PRESSURE SWITCH**

**F5**

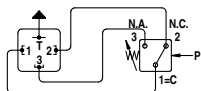
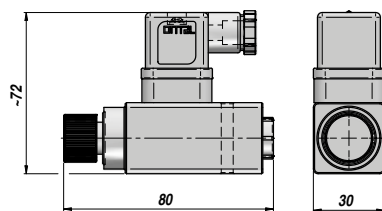
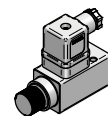

Codice Code	Tipo Type	Campo di Regolazione Setting Range	Esecuzione Execution	P MAX bar	Filetto Thread BSP	kg
APIF530000	F53	5 > 50 bar		300		0,15
APIF550000	F55	15 > 150 bar	Piston	350	1/4"	0,15
APIF570000	F57	30 > 300 bar		400		0,15

Temperatura d'esercizio - Working temperature : -20°C - +80°C

MATERIALE CORPO : ALLUMINIO  
BODY MATERIAL : ALUMINIUM

**PRESSOSTATO REGOLABILE CON CAPPUCCIO DI PROTEZIONE (P1)  
ADJUSTABLE PRESSURE SWITCH WITH PROTECTION CAP (P1)**

**F4**

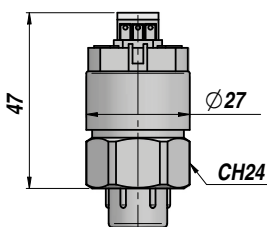
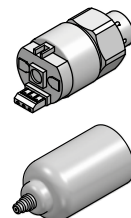

P1

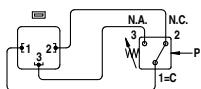

Codice Code	Tipo Type	Campo di Regolazione Setting Range	Esecuzione Execution	P MAX bar	Filetto Thread BSP	kg
APIF4R10P2	F4R-1-P2+P1	0.2 > 2.5 bar	Membrane	25		0,05
APIF4S10P2	F4S-1-P2+P1	1 > 12 bar	Membrane	25		0,05
APIF4T10P2	F4T-1-P2+P1	5 > 50 bar	Piston	300		0,05
APIF4V10P2	F4V-1-P2+P1	10 > 100 bar	Piston	300	1/4"	0,05
APIF4Z10P2	F4Z-1-P2+P1	20 > 200 bar	Piston	300		0,05
APIF4Y10P2 <b>NEW!</b>	F4Y-1-P2+P1	50 > 400 bar	Piston	600		0,05

Temperatura d'esercizio - Working temperature : -20°C - +80°C

MATERIALE CORPO : ACCIAIO  
BODY MATERIAL : STEEL