

TUBO FLESSIBILE - EXCEED EN 857-1SC
FLEXIBLE HYDRAULIC HOSE - EXCEED EN 857-1SC

NEW!

1SC

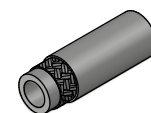
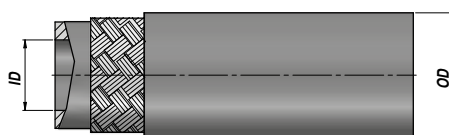

Codice Code	ID				OD mm	P MAX bar		BR min mm	Temperatura d'esercizio Working temperature	Colore Colour	Ghiera Ferrule	kg x 100 m
	size	inch	mm	DN		Esercizio Work	Scoppio Burst					
FGFE001K04	04	1/4"	6.4	06	12.3	225	900	50	-40°C - +100°C (120° intermittente - intermittent)	Nero Black	RPG001C.04	18,20
FGFE001K05	05	5/16"	8.0	08	13.5	215	860	55			RPG001C.05	20,30
FGFE001K06	06	3/8"	9.5	10	15.7	180	720	60			RPG001C.06	24,80
FGFE001K08	08	1/2"	12.7	13	18.9	160	640	70			RPG001C.08	34,10
FGFE001K10	10	5/8"	16.0	16	22.4	130	520	90			RPG001C.10	42,10
FGFE001K12	12	3/4"	19.0	20	25.9	105	420	100			RPG001C.12	49,20
FGFE001K16	16	1"	25.4	25	33.7	88	352	180			RPG001C.16	74,20

BR min = Raggio minimo di curvatura - Minimum bending radius

Sottostrato - Internal hose : Gomma sintetica resistente agli oli idraulici - Hydraulic oil resistant synthetic rubber

Rinforzo - Reinforcement : 1 Treccia in acciaio ad alta tenacità - 1 High tensile steel wire braid

Copertura - Cover : Gomma sintetica resistente agli oli, all'abrasione e agli agenti atmosferici - Oil, abrasion and weather resistant synthetic rubber

TUBO FLESSIBILE - EN 857-2SC
FLEXIBLE HYDRAULIC HOSE - EN 857-2SC

NEW!

2SC

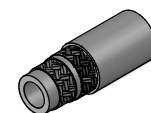
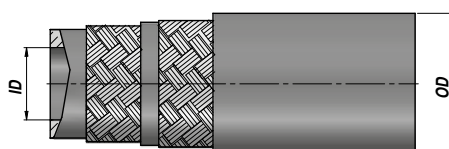

Codice Code	ID				OD mm	P MAX bar		BR min mm	Temperatura d'esercizio Working temperature	Colore Colour	Ghiera Ferrule	kg x 100 m
	size	inch	mm	DN		Esercizio Work	Scoppio Burst					
FGFE002K04	04	1/4"	6.4	06	13.3	400	1600	50	-40°C - +100°C (120° intermittente - intermittent)	Nero Black	RPG001C.04	28,10
FGFE002K05	05	5/16"	8.0	08	14.8	350	1400	55			RPG001C.05	32,70
FGFE002K06	06	3/8"	9.5	10	17.1	330	1320	65			RPG001C.06	41,80
FGFE002K08	08	1/2"	12.7	13	20.4	275	1100	90			RPG001C.08	52,50
FGFE002K10	10	5/8"	16.0	16	23.5	250	1000	100			RPG001C.10	62,70
FGFE002K12	12	3/4"	19.0	20	27.6	215	860	120			RPG001C.12	78,20
FGFE002K16	16	1"	25.4	25	35.8	165	660	150			RPG001C.16	117,60

BR min = Raggio minimo di curvatura - Minimum bending radius

Sottostrato - Internal hose : Gomma sintetica resistente agli oli idraulici - Hydraulic oil resistant synthetic rubber

Rinforzo - Reinforcement : 2 Treccie in acciaio ad alta tenacità - 2 High tensile steel wire braids

Copertura - Cover : Gomma sintetica resistente agli oli, all'abrasione e agli agenti atmosferici - Oil, abrasion and weather resistant synthetic rubber