

TUBO FLESSIBILE LONG LIFE - EN 857-1SC
LONG LIFE FLEXIBLE HYDRAULIC HOSE - EN 857-1SC

NEW!

1SC-LL

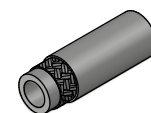
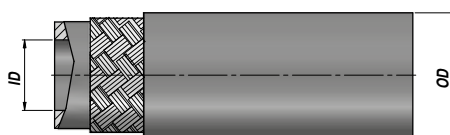

Codice Code	ID				OD mm	P MAX bar		BR min mm	Temperatura d'esercizio Working temperature	Colore Colour	Ghiera Ferrule	kg x 100 m
	size	inch	mm	DN		Esercizio Work	Scoppio Burst					
FGHE101K04	04	1/4"	6.4	06	12.3	250	1120	50	-40°C - +120°C (135° intermittente - intermittent)	Nero Black	RPG001C.04	18,20
FGHE101K05	05	5/16"	8.0	08	13.5	250	1000	55			RPG001C.05	21,00
FGHE101K06	06	3/8"	9.5	10	15.7	250	1000	60			RPG001C.06	24,80
FGHE101K08	08	1/2"	12.7	13	18.9	200	800	70			RPG001C.08	39,10
FGHE101K10	10	5/8"	16.0	16	22.4	150	600	90			RPG001C.10	41,00
FGHE101K12	12	3/4"	19.0	20	26.0	150	600	100			RPG001C.12	53,40
FGHE101K16 NEW!	16	1"	25.4	25	33.7	110	440	180			RPG001C.16	74,20

BR min = Raggio minimo di curvatura - Minimum bending radius

Sottostrato - Internal hose : Gomma sintetica, estrusa senza giunzioni e di spessore uniforme - Synthetic rubber, extruded whole without joints, of uniform thickness

Rinforzo - Reinforcement : 1 Treccia in acciaio ad alta resistenza - 1 High tensile steel wire braids

Copertura - Cover : Gomma liscia sintetica resistente agli oli, all'abrasione e agli agenti atmosferici - Oil, abrasion and weather resistant smooth synthetic rubber

TUBO FLESSIBILE LONG LIFE - EN 857-2SC
LONG LIFE FLEXIBLE HYDRAULIC HOSE - EN 857-2SC

NEW!

2SC-LL

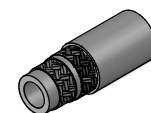
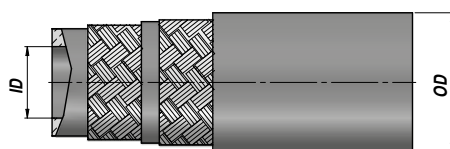

Codice Code	ID				OD mm	P MAX bar		BR min mm	Temperatura d'esercizio Working temperature	Colore Colour	Ghiera Ferrule	kg x 100 m
	size	inch	mm	DN		Esercizio Work	Scoppio Burst					
FGHE102K04	04	1/4"	6.4	06	13.3	430	1720	50	-40°C - +120°C (135° intermittente - intermittent)	Nero Black	RPG001C.04	28,30
FGHE102K05	05	5/16"	8.0	08	14.8	400	1600	60			RPG001C.05	32,40
FGHE102K06	06	3/8"	9.5	10	17.1	350	1400	70			RPG001C.06	41,80
FGHE102K08	08	1/2"	12.7	13	20.4	310	1240	80			RPG001C.08	52,10
FGHE102K10	10	5/8"	16.0	16	23.5	280	1120	100			RPG001C.10	62,60
FGHE102K12	12	3/4"	19.0	20	27.6	240	960	120			RPG001C.12	76,40
FGHE102K16	16	1"	25.4	25	35.8	185	740	160			RPG001C.16	117,10

BR min = Raggio minimo di curvatura - Minimum bending radius

Sottostrato - Internal hose : Gomma sintetica, estrusa senza giunzioni e di spessore uniforme - Synthetic rubber, extruded whole without joints, of uniform thickness

Rinforzo - Reinforcement : 2 Treccie in acciaio ad alta resistenza - 2 High tensile steel wire braids

Copertura - Cover : Gomma liscia sintetica resistente agli oli, all'abrasione e agli agenti atmosferici - Oil, abrasion and weather resistant smooth synthetic rubber