

VALVOLA LIMITATRICE DI PRESSIONE (DIFFERENZIALE)  
RELIEF VALVE (DIFFERENTIAL TYPE)

VMPP

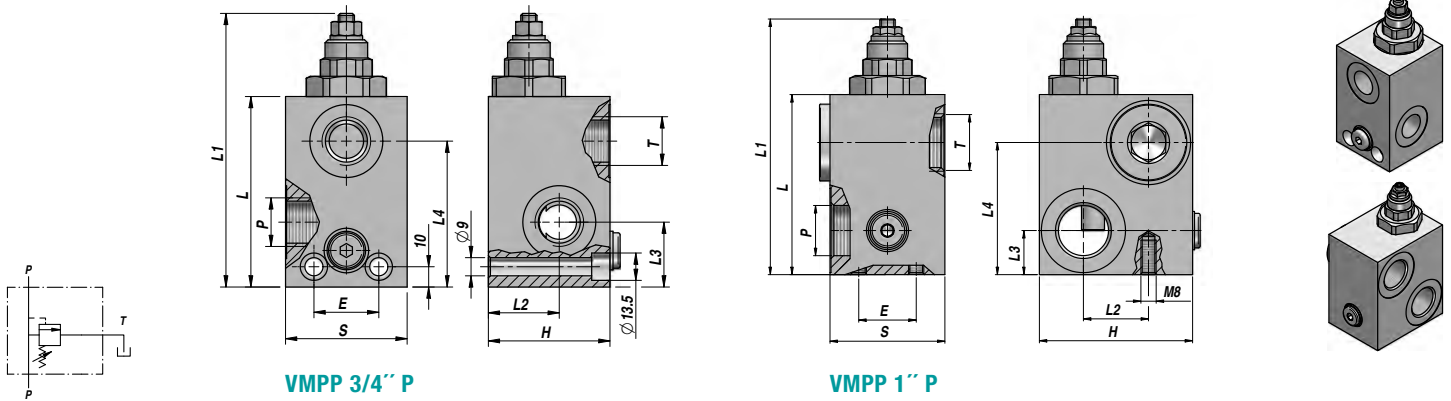

Codice Code	P BSP	T BSP	Q MAX l/min	P MAX bar	Tipo Type	L	L1	L2	L3	L4	E	H	S	kg
V0120.3512	3/4"	3/4"	120	400	VMPP 3/4" P	94	146	35	32	70	32	60	60	2,20
V0120.3516	1"	1"	160	400	VMPP 1" P	94	146	34	23	71	30	60	60	2,90

MOLLA - SPRING : N= 20:200 bar - P= 50:400 bar ( Standard )

MATERIALE CORPO : ACCIAIO  
BODY MATERIAL : STEEL

MONTAGGIO IN LINEA  
LINE MOUNTING

VALVOLA DI ESCLUSIONE ALTA-BASSA PRESSIONE  
"HI-LOW" UNLOADING VALVE

VABP

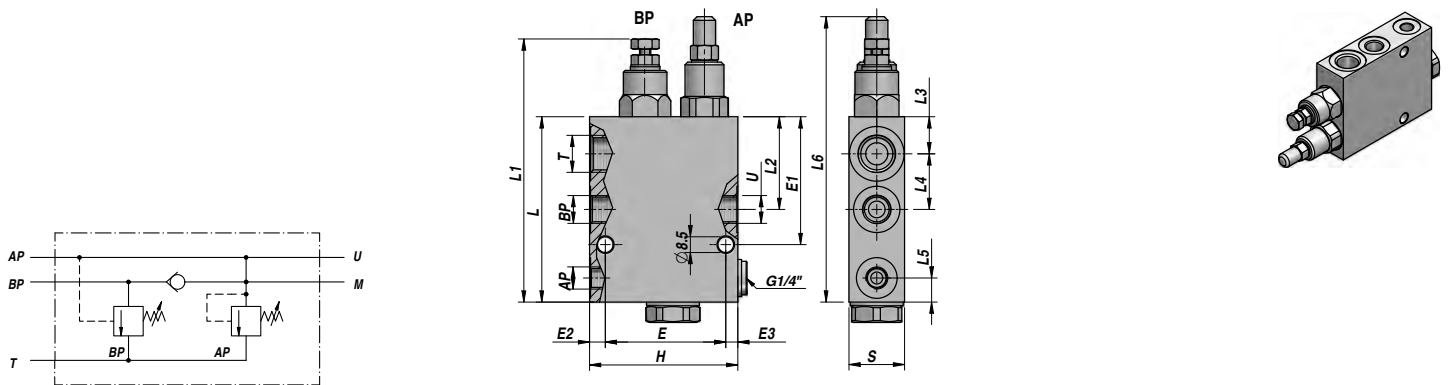

Codice Code	AP BSP	BP-U BSP	T BSP	Q MAX l/min	P MAX bar	Tipo Type	L	L1	L2	L3	L4	L5	L6	E	E1	E2	E3	H	S	kg
V1290.0512	1/4"	3/8"	1/2"	60	300	VABP 3/8"	100	142	50.0	20	30.0	13	155	65	69	8.5	6.5	80	30	1,75
V1290.0513	3/8"	1/2"	3/4"	80	350	VABP 1/2"	105	147	54.0	18	36.0	15	160	65	73	17.0	8.0	90	35	2,33
V1290.0514	1/2"	3/4"	1"	120	350	VABP 3/4"	140	187	52.5	20	42.5	20	212	65	95	27.0	8.0	100	40	3,97

MOLLA "BP" - "BP" SPRING : B= 20:80 bar ( Standard )

MOLLA "AP" - "AP" SPRING : D= 50:350 bar ( Standard )

MATERIALE CORPO : ACCIAIO  
BODY MATERIAL : STEEL

MONTAGGIO IN LINEA  
LINE MOUNTING