

MG3-G

NEW!

MOTORE AD INGRANAGGI GR. 3  
GEAR MOTOR

CORPO : ALLUMINIO  
BASE - COPERCHIO : GHISA  
BODY : ALUMINIUM  
FLANGE - COVER : CAST IRON

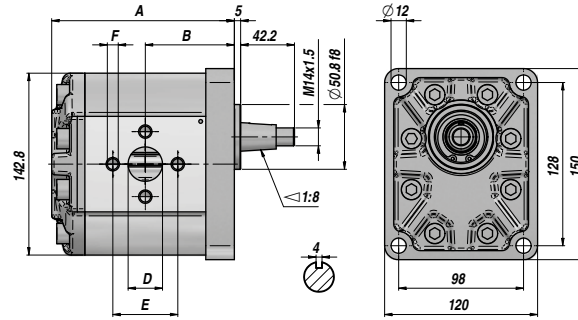
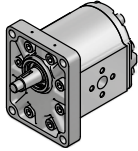

STANDARD EUROPEO BASE  $\varnothing 50.8$   
ALBERO CONICO 1:8  
STANDARD EUROPEAN  $\varnothing 50.8$  FLANGE  
1:8 TAPER SHAFT

Codice Code	Tipo Type	cm <sup>3</sup> /giro cm <sup>3</sup> /rev	P MAX bar		giri/min rpm		A	B	INLET D x E x F	OUTLET D x E x F	kg
			P1	P2	MAX	MIN					
MG8G119*0011000	MG3-G 19 S/D EUR-HN-10-0N	19.30	250	270	3500	700	128.30	62.40	$\varnothing 19 \times 40 \times M8$	$\varnothing 27 \times 51 \times M10$	7,67
MG8G123*0011000	MG3-G 23 S/D EUR-HN-10-0N	23.00	240	260	3500	700	131.30	63.90	$\varnothing 19 \times 40 \times M8$	$\varnothing 27 \times 51 \times M10$	7,81
MG8G130*0011000	MG3-G 30 S/D EUR-HN-10-0N	30.20	220	240	3300	700	137.30	66.90	$\varnothing 19 \times 40 \times M8$	$\varnothing 27 \times 51 \times M10$	8,09
MG8G134*0011000	MG3-G 34 S/D EUR-HN-10-0N	33.80	220	230	3300	700	140.30	68.40	$\varnothing 19 \times 40 \times M8$	$\varnothing 27 \times 51 \times M10$	8,22
MG8G137*0011000	MG3-G 37 S/D EUR-HN-10-0N	37.50	210	230	3300	700	143.30	69.90	$\varnothing 19 \times 40 \times M8$	$\varnothing 27 \times 51 \times M10$	8,36
MG8G144*0011000	MG3-G 44 S/D EUR-HN-10-0N	44.60	200	220	3000	700	149.30	72.90	$\varnothing 19 \times 40 \times M8$	$\varnothing 27 \times 51 \times M10$	8,64
MG8G153*0011000	MG3-G 53 S/D EUR-HN-10-0N	53.00	200	210	3000	700	156.30	76.40	$\varnothing 19 \times 40 \times M8$	$\varnothing 27 \times 51 \times M10$	8,96
MG8G162*0011000	MG3-G 62 S/D EUR-HN-10-0N	62.70	180	190	2500	700	164.30	80.40	$\varnothing 19 \times 40 \times M8$	$\varnothing 27 \times 51 \times M10$	9,33
MG8G170*0011000	MG3-G 70 S/D EUR-HN-10-0N	70.50	180	200	2500	700	170.80	86.90	$\varnothing 19 \times 40 \times M8$	$\varnothing 27 \times 51 \times M10$	9,63
MG8G177*0011000	MG3-G 77 S/D EUR-HN-10-0N	77.20	170	190	2200	700	176.30	92.40	$\varnothing 19 \times 40 \times M8$	$\varnothing 27 \times 51 \times M10$	9,88

\* 1= ROTAZIONE SINISTRA - ANTICLOCKWISE  
\* 0= ROTAZIONE DESTRA - CLOCKWISE

P1 = PRESSIONE MAX. DI ESERCIZIO - MAX. WORKING PRESSURE  
P2= PRESSIONE MAX. INTERMITTENTE - MAX. INTERMITTEN PRESSURE

FLANGE DISPONIBILI - AVAILABLE FLANGES

SAE-B

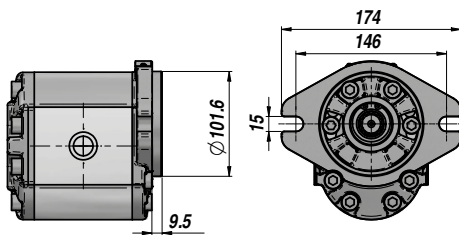

A RICHIESTA - ON REQUEST :

- MG3-GR = ROTAZIONE BIDIREZIONALE - BI-DIRECTIONAL ROTATION
- VLP-I = COPERCHIO CON VALVOLA LIMITATRICE DI PRESSIONE - COVER WITH RELIEF VALVE

ALBERI DISPONIBILI - AVAILABLE SHAFTS

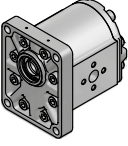
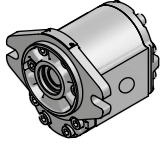
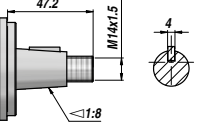
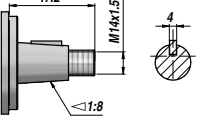
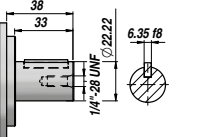
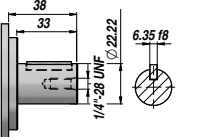
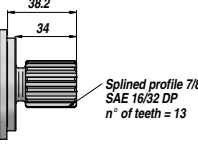
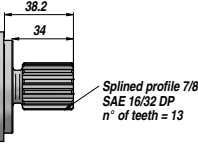
EURO	SAE-B			
				
10 	10 			
13 	13 			
14 	14 			

CONNESSIONI - CONNECTIONS

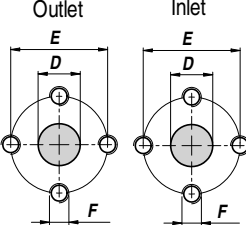
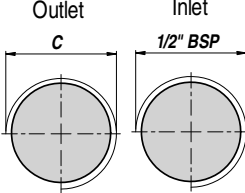
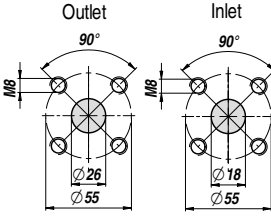
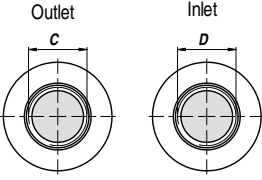
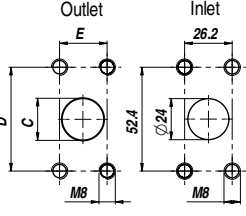
N (EURO)	G (GAS)	T (BOSCH)	W (UNF)	F (SAE)
<p>Outlet Inlet</p>  <p>Dimensioni : vedi tabella a lato Dimensions : see table on the left</p>	<p>Outlet Inlet</p>  <p>C= 1" - D= 3/4" (cm<sup>3</sup> 19 ÷ 62) C= 1"1/4 - D= 1" (cm<sup>3</sup> 70 ÷ 77)</p>	<p>Outlet Inlet</p> 	<p>Outlet Inlet</p>  <p>C= 1"5/16 - D= 1"1/16 (cm<sup>3</sup> 19 ÷ 30) C= 1"5/8 - D= 1"5/16 (cm<sup>3</sup> 34 ÷ 62) C= 1"7/8 - D= 1"5/8 (cm<sup>3</sup> 70 ÷ 77)</p>	<p>Outlet Inlet</p>  <p>C=27 - D=52.4 - E=26.2 (cm<sup>3</sup> 19 ÷ 37) C=42 - D=35.6 - E=69.8 (cm<sup>3</sup> 44 ÷ 77)</p>